

Thank you for purchasing Bell+Howell® Bionic™ Burner™. Combat weeds with the power of hot air! 1,000°F (550°C) jet of hot air effectively and permanently kills all weeds. It has a powerful 1500 watt output, does not use gas cartridge and it's chemical free. May also be used to remove paint and varnish.



IMPORTANT SAFEGUARDS

In order to avoid damage and dangers due to improper use, read the entire manual carefully, and retain it for future reference.

1. **FIRE HAZARD** - Follow the instructions in this manual carefully, and handle the device with care.
2. Particular care is required when using the device in proximity to flammable materials.
3. Do not point the device at the same place for extended periods of time.
4. Never leave the device unattended while switched on.
5. Heat can be conducted to combustible materials that are not in the line of vision.
6. Make sure that the attachments are correctly attached to the device.
7. The cable and other flammable materials must not come into contact with the hot components or nozzles.
8. **RISK OF BURNS!** Some parts of the device get very hot during use, never touch hot areas!
9. **NEVER** point the hot air stream at people or animals.
10. Never touch the heat shield or nozzle during operation.
11. This device should only be used by children aged 8 years and over, as well as by persons with reduced physical, sensory or mental abilities or lack of experience and knowledge, if they are supervised or have been instructed on the safe use of the device and understand the dangers associated with its use. Children must never be allowed to play with the device. Cleaning and user maintenance must never be performed by children unless they are aged 8 years or over and supervised by an adult. Children younger than 8 years of age are to be kept away from the device and the connection cable.
12. This device is only suitable for private and domestic use in the yard or garden. Only for removing overgrowth and weeds between and around paving stones and slabs, masonry, flower beds and lawns. In addition, the product can be used to remove paint and varnish.
13. Hazards can arise if the device is not used as intended. Only use the device for its intended purpose and observe all notes and instructions laid out in this manual.
14. Never attempt to repair or modify the device yourself. For repairs, please contact customer service.
15. Never use the device if you are tired, ill, or under the influence of alcohol, drugs or medication.
16. Always wear sturdy shoes during use. We recommend that you wear protective gloves.
17. **RISK OF ELECTRIC SHOCK** if electrically conductive lines or components come into contact with the device.
18. Never use the device if the cable is damaged. If necessary, contact customer service.
19. The voltage must match what is specified on the device.
20. Connect to only alternating current and a shock-proof socket.
21. If using an extension cable, use the one with an earthed cable suitable for outdoor use, with a conductor cross-section of at least 16 - 14 Gauge.
22. Unplug the power cord immediately if problems arise during operation, after use, and before cleaning.
23. Never use or touch the device or plug with wet hands.
24. Never immerse or clean the device in water. Always protect the device against moisture. If the device falls into water, remove the plug from the power outlet immediately! **NEVER** reach into the water while the device is still connected to the power outlet!
25. **DANGER TO LIFE DUE TO FIRE AND/OR EXPLOSION!**
 - a. Only for outdoor use. Never use in a garage or locations where liquid fuels or highly flammable materials may be stored or used.

- b. Do not use in the vicinity of easily flammable substances or gases.
- c. Never direct the hot air stream at flammable objects (e.g. gas bottles).
- Always keep away from sources of ignition.
- d. Do not smoke during use.
- e. Keep out of reach of children.

- 26. Protect from extended exposure to sunlight and frost.
- 27. **FIRE HAZARD!** Dry plants, grasses, pine needles, leaves and wood can catch fire. Observe the treated plant for a while after application. It could take some time before the plant catches fire.
- 28. In the event of an unexpected fire, make sure that there is no danger to yourself, and then extinguish the fire with a suitable fire extinguisher.



Risk of burns! Never touch hot surfaces.



Protect from moisture and rain.

PARTS IDENTIFICATION

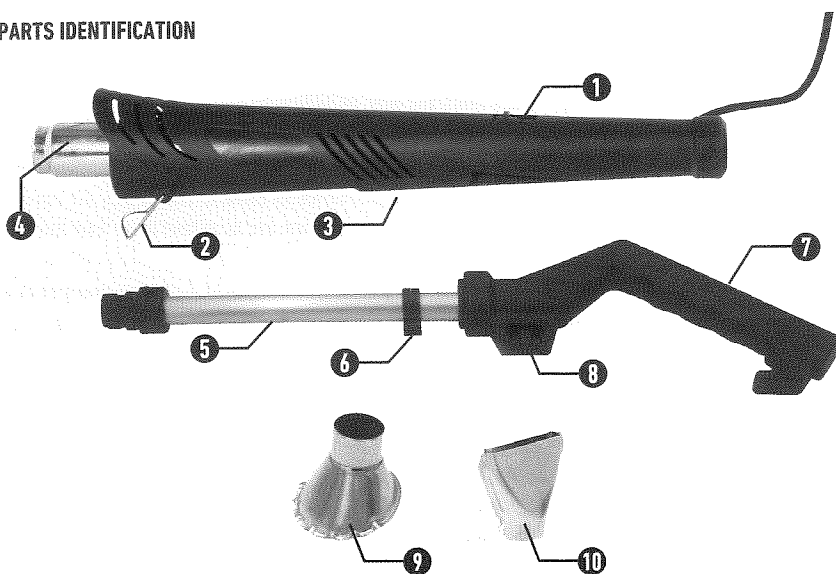

- 1. ON/OFF switch and power control
- 2. Stand
- 3. Air outlet openings
- 4. Hot air nozzle

- 5. Extension pole with grip
- 6. Cable guide
- 7. Handle
- 8. Cable clamp

- 9. Conical nozzle
- 10. Crevice nozzle

UNPACKING

Remove any packaging material. Dispose of the packaging material. Keep all of the components together.

ASSEMBLY

STEP 1: ASSEMBLING THE POLE WITH HANDLE

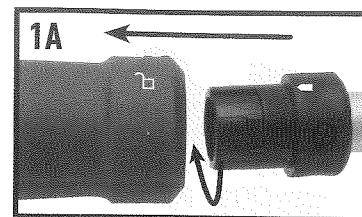

1. Align the arrow mark on the pole with the on the unit. See Diagram 1A. Push the pole in until it's fully inserted.

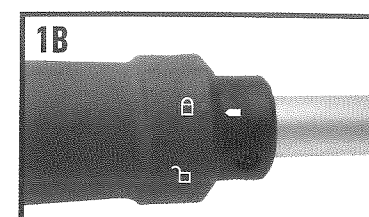

2. Turn the pole clockwise until the arrow mark on the pole aligns with the symbol. See Diagram 1B.

STEP 2: SECURE CORD TO CLAMP

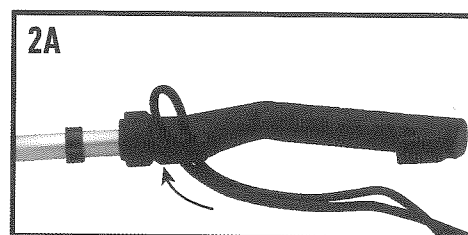

- Push the cable through the opening on the handle. Form a loop with the cable.

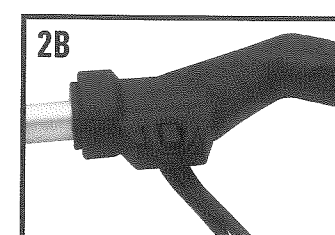

- Route the cable around the cable clamp, and draw the cable tight.

ATTACHMENTS (CONICAL and CREVICE)



Conical nozzle:
Use for larger areas.



Crevice nozzle:
Use for small, narrow areas.

IMPORTANT: When removing/changing attachments device must be switched off, disconnected from power, and cooled.

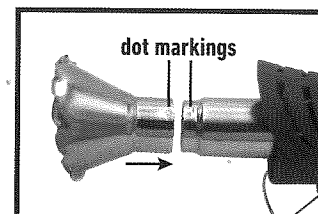

1. Align the markings of the attachment with the markings on the hot air nozzle.

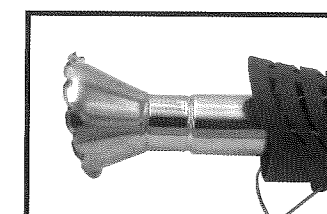

2. Slide the attachment into the hot air nozzle. Lock the attachment by turning counterclockwise. Make sure that the attachment is securely locked in place.

USAGE - WEED REMOVAL

1. Connect the power cord to the outlet. You may use extension cord, if needed.

2. Point the hot air nozzle with the desired attachment away from the body.

3. Slide the ON/OFF switch to position II. Allow the device to heat up for approx. 45 seconds. Make sure that you do not allow the nozzle to rest on sensitive surfaces such as wood, as this could lead to scorch marks.

4. Hold the unit with conical or crevice nozzle over the weeds for at least 5 seconds. In the case of more persistent weeds or plants with thick, deep roots (e.g. dandelions) increase the duration of application. This usually kills the weeds within 24 hours. It is not necessary to completely burn the weeds. A few seconds are sufficient - even if the visible part of the weed still appears green, this is completely normal. The effect will be visible in the next few hours.

5. For best results, the nozzle should be placed no higher than 2 inches (5 cm) over the weeds. **Never place the conical or crevice nozzle directly on the ground. This could lead to a build-up of heat and damage to the device.**

6. **EXTREMELY IMPORTANT:** To turn the unit OFF, FIRST slide the ON/OFF switch to the "I" position and keep it there for at least 1 minute. The device can be placed on the stand while it cools down. Never leave the device unattended while it's cooling down. After at least 1 minute you can move the switch to "0" to completely turn off the unit. Unplug the unit.

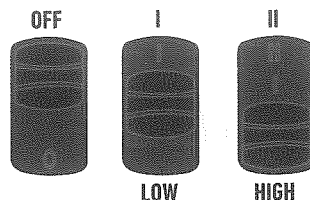

USAGE - PAINT/VARNISH REMOVAL (without attachment)

1. Connect the power cord to the outlet. You may use extension cord, if needed.

2. Point the hot air nozzle away from the body.

3. Slide the ON/OFF switch to position II. Allow the device to heat up for approx. 45 seconds. Make sure that you do not allow the nozzle to rest on sensitive surfaces such as wood, as this could lead to scorch marks.

4. Hold the hot air nozzle over the painted area for at least 5 seconds. Move in sections until the area is complete. Use a rag to wipe up the paint residue.

5. For best results, the nozzle should be placed no higher than 2 inches (5 cm) over the area. **Never place the hot air nozzle directly on the painted surface. This could lead to a build-up of heat and damage to the device.**

6. **EXTREMELY IMPORTANT:** To turn the unit OFF, FIRST slide the ON/OFF switch to the "I" position and keep it there for at least 1 minute. The device can be placed on the stand while it cools down. Never leave the device unattended while it's cooling down. After at least 1 minute you can move the switch to "0" to completely turn off the unit. Unplug the unit.

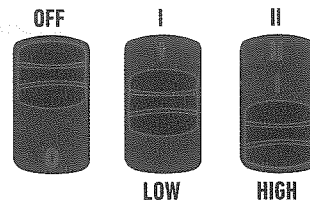

HELPFUL TIPS

- The thicker the root, the longer you should hold the device over the plant in order to achieve the lasting effect of permanent weed removal. For weeds with particularly thick and/or deep roots (e.g. dandelions) it may be necessary to repeat the treatment several times at intervals of 1-2 weeks.
- Overly moist soil or damp roots can reduce the effectiveness of the device. In such a case, repeat the treatment in drier conditions if necessary. Never use the device immediately after it has rained.

STORAGE

- **WARNING!** Always make sure to follow the correct cooling directions before turning the unit OFF. Remove the plug from the outlet, and ensure that the device has cooled down completely. Refer to page 4 (Step 6) on how to properly cool down and turn off the unit.
- Never leave the device unattended while it's cooling down.
- Make sure that the device has cooled down completely before storage.

CLEANING AND CARE

WARNING! Always make sure to follow the correct cooling directions before turning the unit OFF. Remove the plug from the outlet, and ensure that the device has cooled down completely.

- It is recommended to clean the device after each use with a damp cloth and some mild detergent.
- Keep away from water.
- Do not use aggressive cleaning agents, as they can damage the unit.
- Keep the ventilation openings and the motor housing free of dust and dirt.

SPECIFICATIONS

Output: 120V-60Hz

Rated capacity: 12.5Amps, 1500 Watts

Airflow: 500l/min

Temperature level I (fan/cooling): 140°F (60°C)

Temperature level II: 1000°F (550°C)

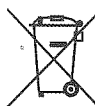

Do not dispose this product at the end of its service life through normal domestic waste. It has to be disposed through a collection agency that recycles electric and electronic devices. This is pointed out by the symbol on the product, in the instruction manual, and on the packaging. Please inquire about local collection agencies that may be operated by your distributor or your municipal administration. By recycling, making use of the materials, or other forms of recycling old units you are making an important contribution to protecting our environment.

BELL+HOWELL

BIONICTM BURNERTM

EMSON

AS SEEN ON
TV

SAFE!

**NO HARMFUL
CHEMICALS**

**1500
WATTS**

**WIDE
NOZZLE**

**CREVICE
NOZZLE**

**PAINT
REMOVAL**

**KILLS AT THE
ROOT!**

INSTRUCTIONS